

SECTION RELOCATED
MUD CREEK
NO SCALE

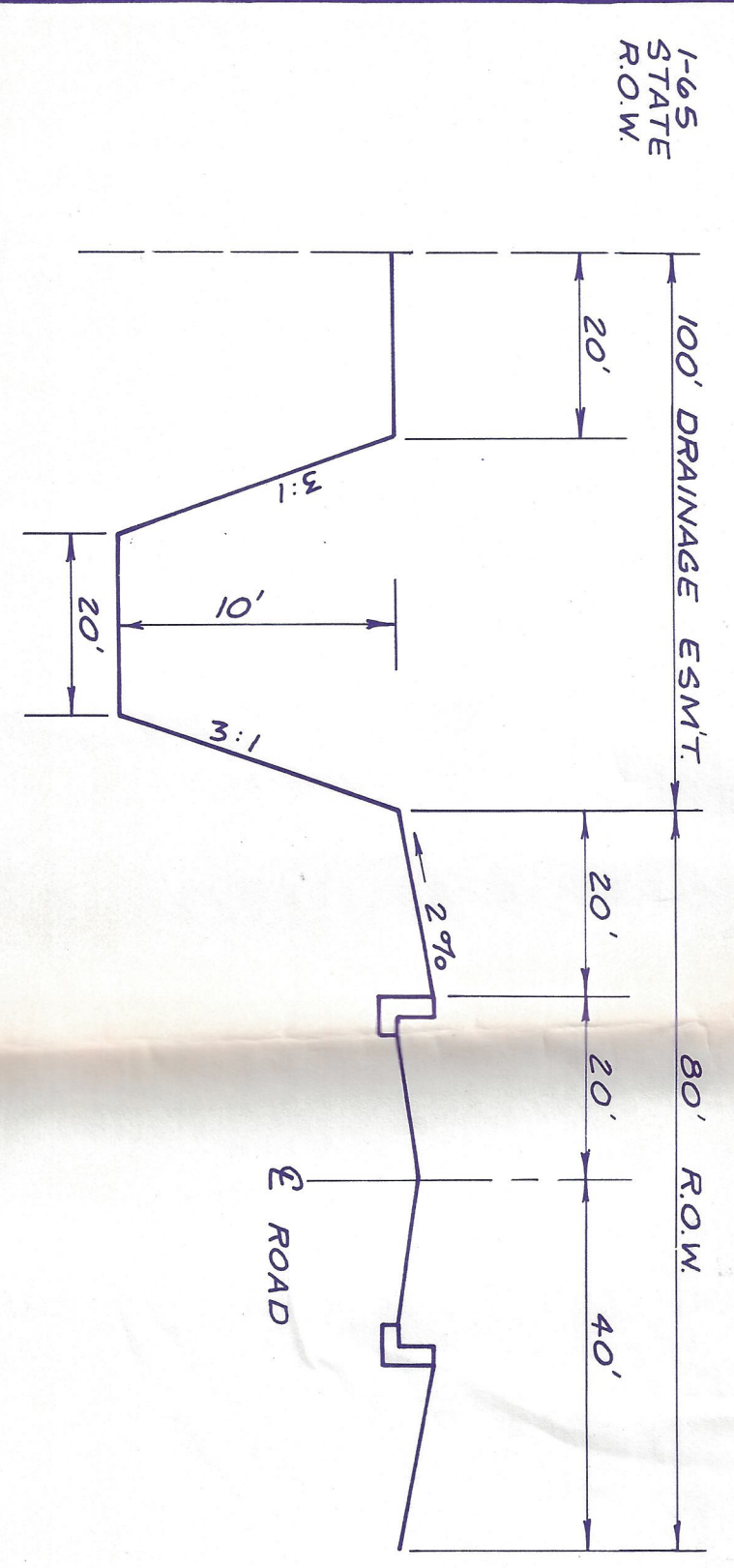

LOCATION MAP
NO SCALE

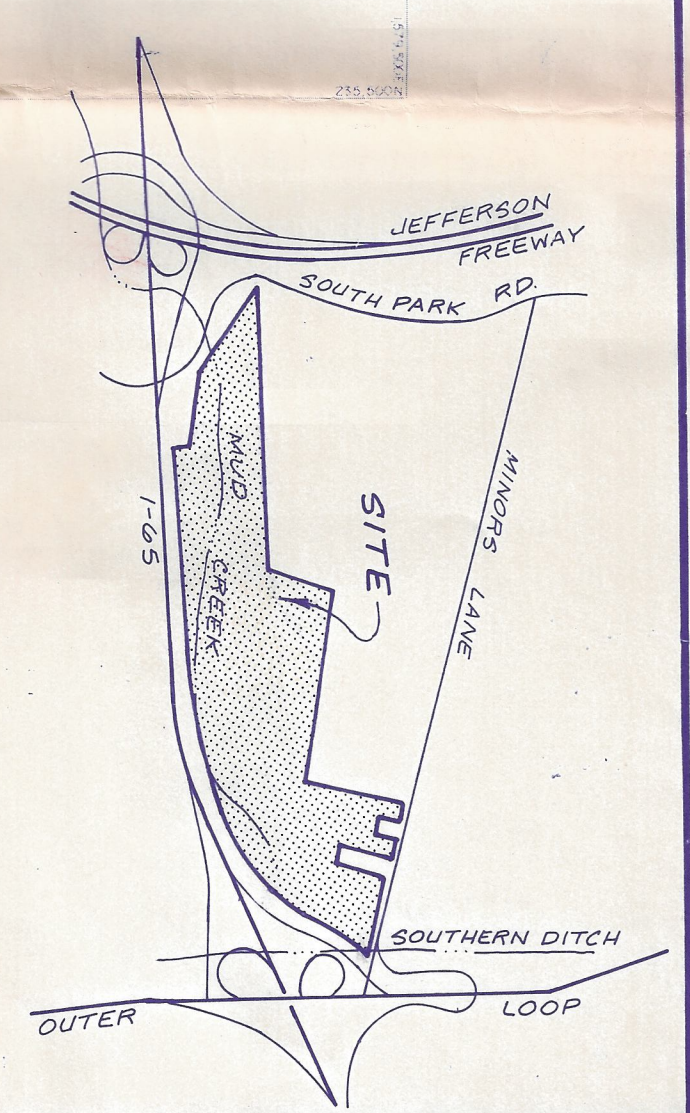

DATA

TOTAL ACRES	164 ± AC.
EXISTING ZONING	R-4
PROPOSED ZONING	C-2, R-B
BUILDING AREA C-2	96,600 SF
PARKING C-2	5,135 SP
BUILDING AREA R-B	68,500 SF
PARKING R-B	38 SP
ACREAGE C-2 ZONING	130.9 AC.
ACREAGE R-B ZONING	49.4 AC.

RETAIL / OFFICE

Building Area (± sq. ft.)	Building
100,000	1. Office
174,000	2. Office
80,000	3. Office
25,000	4. Office
65,000	5. Office
474,000	Total

RESIDENTIAL

30,600	1. Office
28,800	2. Office
50,200	3. Office
33,000	4. Office
33,000	5. Office
18,000	6. Office
28,500	7. Office
34,600	8. Office
117	9. Office
46,400	10. Office
131	11. Office
78	12. Office
9,000	13. Office
6,200	14. Office
4,200	15. Office
4,050	16. Office
9,000	17. Office
4,200	18. Office
4,200	19. Office
24,200	20. Office
17,600	21. Office
42,600	22. Office
452,600	Total

APPROVED FOR DOCKET ONLY
COMMENTS:
BY: *[Signature]*
DATE: *6/18/86*
JEFFERSON COUNTY
DEPT. OF PUBLIC WORKS

DISTRICT DEVELOPMENT PLAN
CROWN POINTE
[Signature]
JUN 26 1986
RECEIVED
LOUISIANA AND JEFFERSON COUNTY
PLANNING COMMISSION

SABAK, WILSON & LINGO, INC.
ENGINEERS, LANDSCAPE ARCHITECTS & PLANNERS
300 WEST MAIN STREET, LOUISVILLE, KENTUCKY 40202 (502) 584-0371

OWNER: LESURE ESTATES INC. B. PARTNERSHIP
2305 PLAINSIDE DRIVE
LOUISVILLE, KY 40299
DEVELOPER: LESURE DEVELOPMENT CO.
2305 PLAINSIDE DRIVE
LOUISVILLE, KY 40299

9-6-4-81