



Comprehensive Plan

Comprehensive Plan Not Followed

- Community Form Goal 1 Policy 17 (*Traffic Mitigation*)
- Community Form Goal 3 Policies 1, 2, 4, 6, 8
(*Usable Open Space, Park Access, Natural Resource Protection*)
- Mobility Goal 1 Policies 1.1, 1.4, 1.5 (*Cyclist/Ped Movement*)
- Mobility Goal 2 Policies 4, 5, 8, 9 (*Safe, Efficient Transportation*)
- Mobility Goal 3 Policies 2, 3, 12, 15 (*Proximate Development*)
- Livability Goal 1 Policies 3, 8, 9, 10
(*Natural Resource Protection/Mitigation*)



Comprehensive Plan

South Floyds Fork Area Study

South Floyds Fork Vision Statement

Floyds Fork watershed is a natural treasure.

The area is defined by rich natural resources, rural landscapes, open spaces, a robust tree canopy, agricultural lands, stream health, parks and recreational areas, dark skies, wildlife habitat, healthy ecosystems, scenic roads and parkways. Protecting, preserving and enhancing these natural, cultural and historic resources while providing sustainable, low-impact and mixed-use developments will reduce environmental impacts.

The preservation of Floyds Fork as a healthy living creek is paramount.

- Based on SFFAS, Floyds Fork DRO down-zoned R-R

“Extensive study”

“A lot of public engagement”

“For the protection of Floyds Fork”

--Emily Liu, Director of Planning

- SFFAS Adopted into Comprehensive Plan

Comprehensive Plan Not Followed

- PRD \neq R-R

Amenities & Recreational Open Space

- No Amenities
- Inadequate Recreational Space

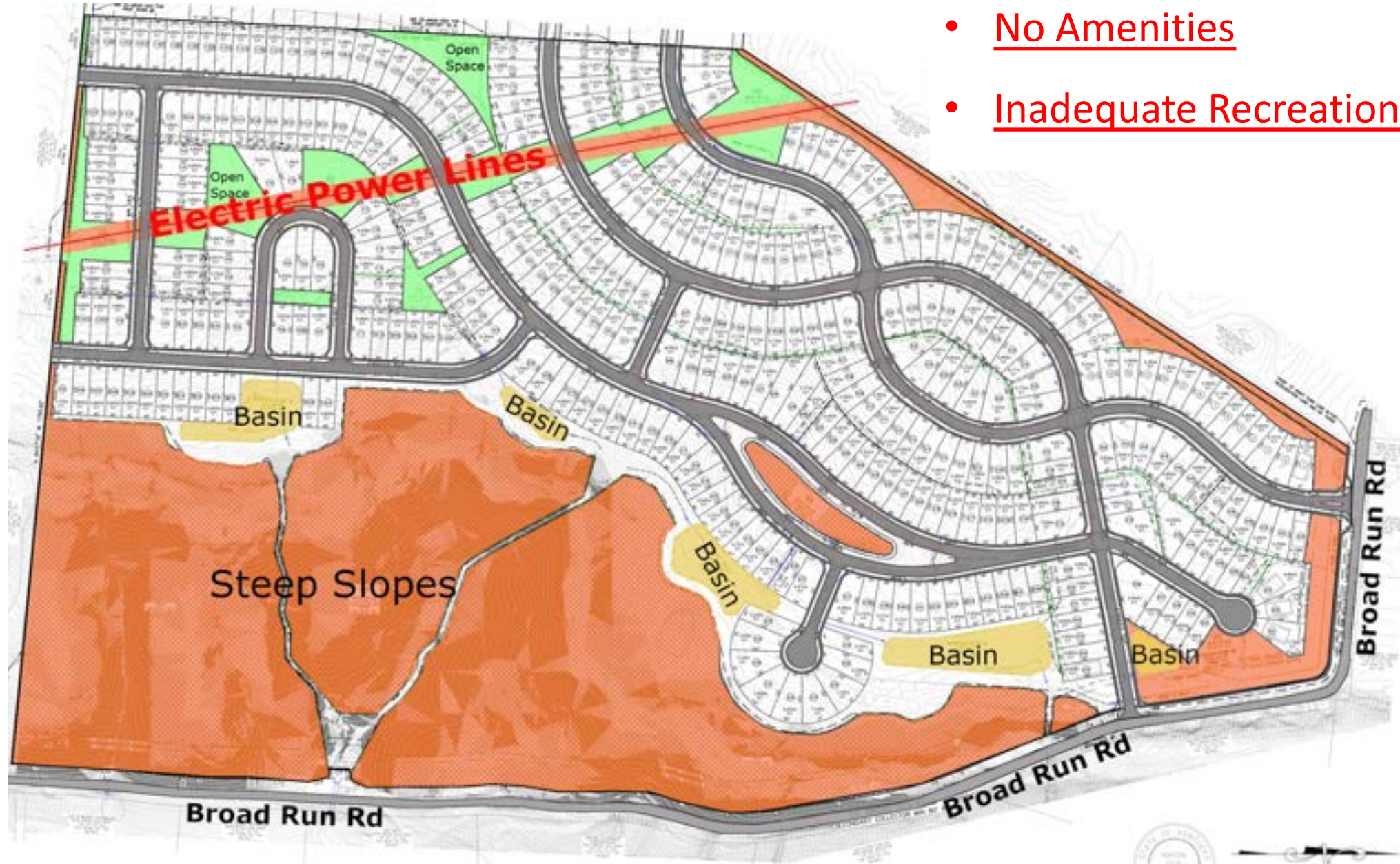

MSD



MSD Does Not Always Have It

- Admittedly Failing Basins
- Admittedly Inadequate Staff
 - Maintenance
 - Inspection
- Request Residents' Help

“We do not protect Floyds Fork, the [FF] DRO does.”

–Tony Parrott, Executive Director MSD

Plan Certain = Plan Maybe

Do Not Approve PRD

- Below R-4 Density
3.86du/acre
- Opens Door to Future Changes

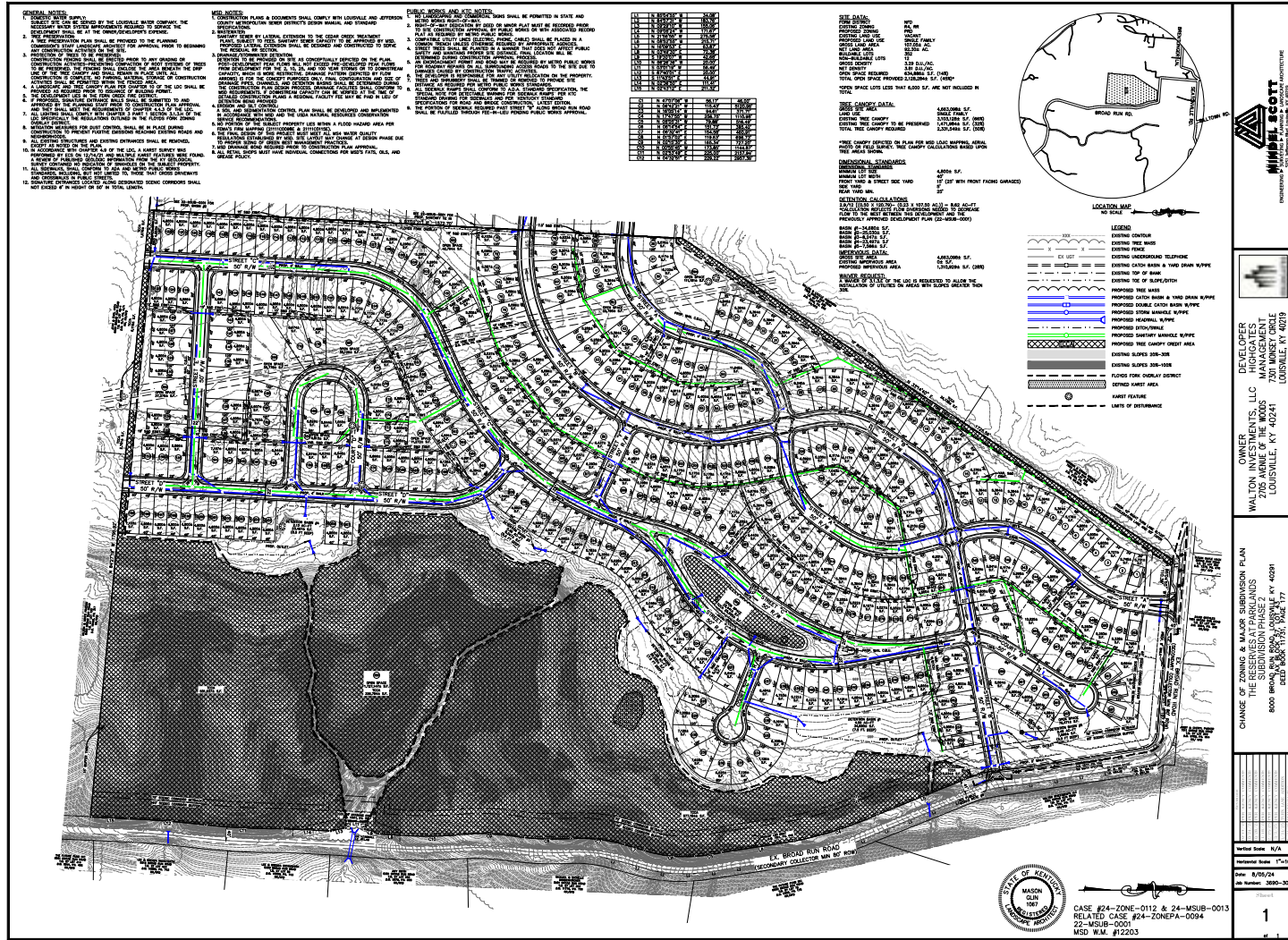

MSD

MSD Does Not Always Have It

Active Sewage Leak



Erosion Prevention/Silt Control



EPSC Measures

Do Not Always Work

Silt fence designed for 10-yr rain event
Silt fence on steep slopes?

