

**AN ORDINANCE CHANGING THE ZONING FROM R-6 MULTI-FAMILY RESIDENTIAL TO EZ-1 ENTERPRISE ZONE ON PROPERTY LOCATED AT 3650 CANE RUN ROAD CONTAINING 3.48 ACRES AND BEING IN LOUISVILLE METRO (CASE NO. 14ZONE1061)**

**SPONSORED BY: COUNCILWOMAN MADONNA FLOOD**

WHEREAS, the Legislative Council of the Louisville/Jefferson County Metro Government (the "Council") has considered the evidence presented at the public hearing held by the Louisville Metro Planning Commission and the recommendations of the Planning Commission and its staff as set out in the minutes and records of the Planning Commission in Case No. 14ZONE1061; and

WHEREAS, the Council concurs in and adopts the findings of the Planning Commission for the zoning change in Case No. 14ZONE1061 and approves and accepts the recommendations of the Planning Commission as set out in said minutes and records;

**NOW THEREFORE BE IT ORDAINED BY THE LEGISLATIVE COUNCIL OF THE LOUISVILLE/JEFFERSON COUNTY METRO GOVERNMENT AS FOLLOWS:**

**Section I:** That the zoning of the property located at 3650 Cane Run Road containing 3.48 acres and being in Louisville Metro, as more particularly described in the minutes and records of the Planning Commission in Case No. 14ZONE1061, is hereby changed from R-6 Multi-Family Residential to EZ-1 Enterprise Zone; provided, however, said property shall be subject to the binding elements as set forth in the minutes of the Planning Commission in Case No. 14ZONE1061.

**Section II:** This Ordinance shall take effect upon its passage and approval.



H. Stephen Ott  
Metro Council Clerk



David Tandy  
President of the Council

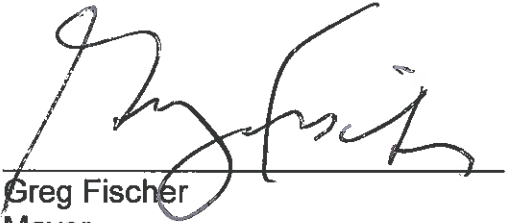

Greg Fischer  
Mayor

Approved:  
Date

6/2/15

**APPROVED AS TO FORM AND LEGALITY:**

Michael J. O'Connell  
Jefferson County Attorney

By: 

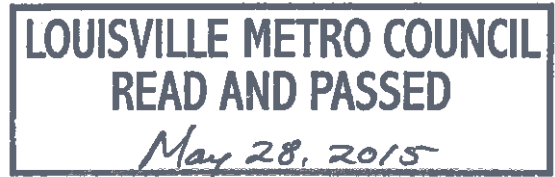

O-108-15

### **PROSECUTION AND SETTLEMENT CONTROL NOTES**

[illegible]

## REFERENCES AND NOTES

- [illegible]

**GENERAL NOTE**

- [illegible]

10. A UNIFORM AND TRUE C

- [illegible]

**Word Mottos**

- [illegible]

- [illegible]

- [illegible]

1997

- [illegible]

- | OVERSIGHT |                         |
|-----------|-------------------------|
| DATE      | DESCRIPTION             |
| 10/1/78   | FOR AUDITORY COMMISSION |
| 10/2/78   | FOR AUDITORY COMMISSION |
| 10/3/78   | FOR AUDITORY COMMISSION |
| 10/4/78   | FOR AUDITORY COMMISSION |
| 10/5/78   | FOR AUDITORY COMMISSION |
| 10/6/78   | FOR AUDITORY COMMISSION |
| 10/7/78   | FOR AUDITORY COMMISSION |
| 10/8/78   | FOR AUDITORY COMMISSION |
| 10/9/78   | FOR AUDITORY COMMISSION |
| 10/10/78  | FOR AUDITORY COMMISSION |
| 10/11/78  | FOR AUDITORY COMMISSION |
| 10/12/78  | FOR AUDITORY COMMISSION |
| 10/13/78  | FOR AUDITORY COMMISSION |
| 10/14/78  | FOR AUDITORY COMMISSION |
| 10/15/78  | FOR AUDITORY COMMISSION |
| 10/16/78  | FOR AUDITORY COMMISSION |
| 10/17/78  | FOR AUDITORY COMMISSION |
| 10/18/78  | FOR AUDITORY COMMISSION |
| 10/19/78  | FOR AUDITORY COMMISSION |
| 10/20/78  | FOR AUDITORY COMMISSION |
| 10/21/78  | FOR AUDITORY COMMISSION |
| 10/22/78  | FOR AUDITORY COMMISSION |
| 10/23/78  | FOR AUDITORY COMMISSION |
| 10/24/78  | FOR AUDITORY COMMISSION |
| 10/25/78  | FOR AUDITORY COMMISSION |
| 10/26/78  | FOR AUDITORY COMMISSION |
| 10/27/78  | FOR AUDITORY COMMISSION |
| 10/28/78  | FOR AUDITORY COMMISSION |
| 10/29/78  | FOR AUDITORY COMMISSION |
| 10/30/78  | FOR AUDITORY COMMISSION |
| 10/31/78  | FOR AUDITORY COMMISSION |

Part

- |                          |              |                  |            |
|--------------------------|--------------|------------------|------------|
| Horizontal Slide 1" x 3" | Date: 2/2/15 | Job Number: 3623 | Sheet<br>1 |
|--------------------------|--------------|------------------|------------|

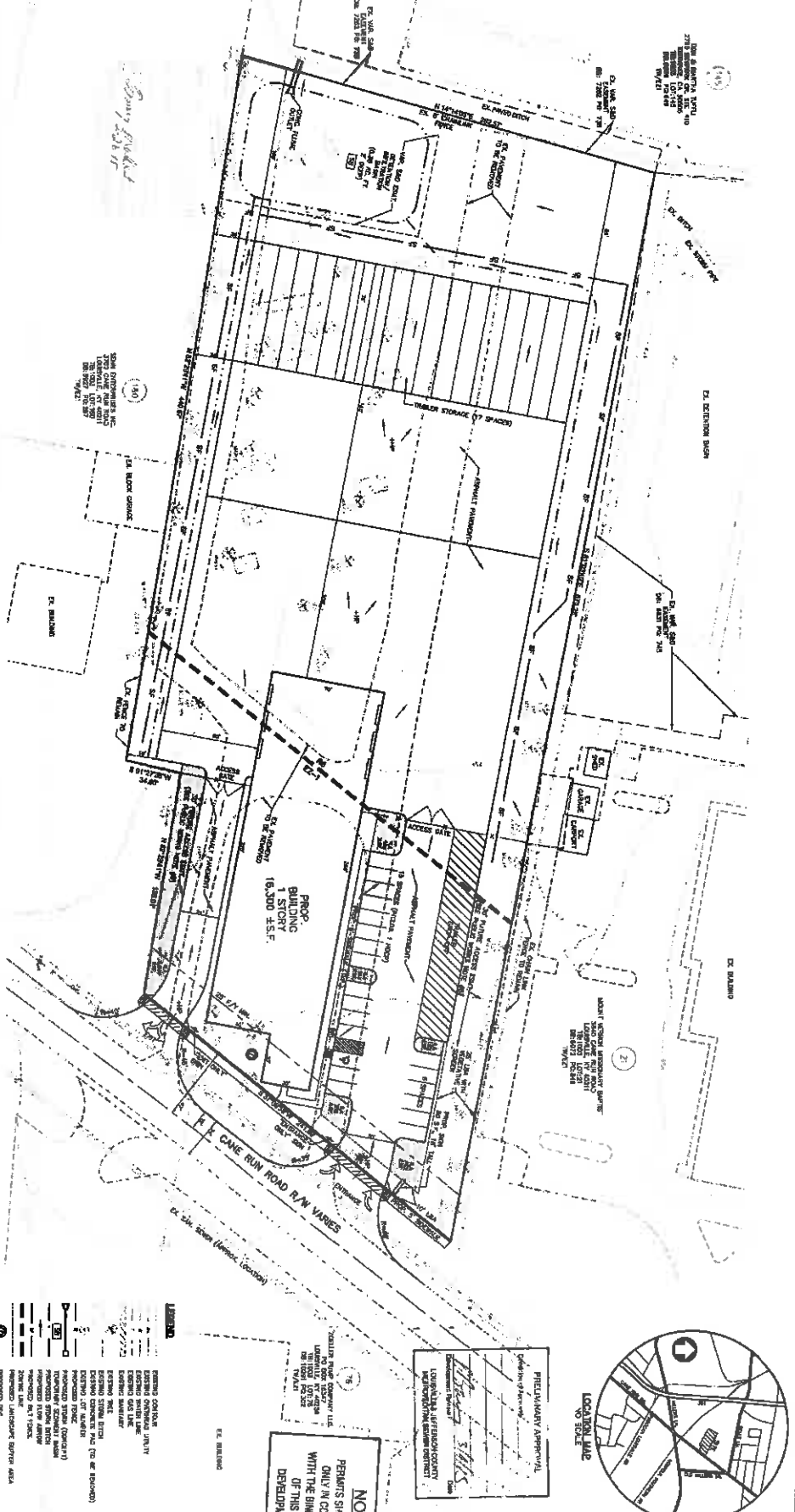

**NOTICE**  
PERMITS SHALL BE ISSUED  
ONLY IN CONFORMANCE  
WITH THE BINDING ELEMENTS  
OF THIS DISTRICT  
DEVELOPMENT PLAN.

OWNER

DETAILED DISTRICT DEVELOPMENT PLAN  
**CANE RUN ROAD FACILITY**  
 3650 CANE RUN ROAD  
 LOUISVILLE, KY 40211  
 TAX BLOCK: 1003, LOT: 152  
 DB: 10294, PG. 145



**Mindel, Scott & Associates, Inc.**  
 Planning • Engineering • Surveying • Landscape Architecture  
 Utility Consulting • Property Management  
 555 Wilshire Blvd., Suite 1200, Los Angeles, CA 90061  
 Phone (213) 461-7200 Fax (213) 461-1011 E-Mail: mindel@msa-inc.com