

# LEGEND

- PROPOSED TRENCHED EDGE
- PROPOSED TREE/SHRUB
- PROPOSED PLANT QUANTITY AND SYMBOL
- PROPOSED SODDED AREA
- PROPOSED LIMESTONE BOULDER (7) SEE L-501 DRIVE THRU OF THE FUTURE DETAIL FOR ADDITIONAL BOULDERS.
- DESERT SAND IN COLOR, 12" TO 36" IN SIZE
- PROPOSED RIVER ROCK MULCH TO MATCH LANDSCAPE MULCH, SEE SHEET L-001.

## LANDSCAPE DATA CHART

VEHICULAR USE AREAS			TREE CANOPY CALC.	
AREA OF VUA 11,898 SF DISTRICT : CAMPUS			CLASS C, 0% PRESERVED TREE CANOPY = 20% TREE CANOPY REQUIRED	
			REQUIRED: 20% OF 54 ACRES = 4,700 SF OF CANOPY	
			PROPOSED: 28% OF 54 ACRES = 6,526 SF OF CANOPY	
VUALBA	REQUIRED	PROVIDED		
FRONT: S. BROOK ST	10'	11.0'		
REAR: CSX RAILROAD	N/A	1.8'		
SIDE: E. BLOOM ST.	10'	3.0'		
SIDE: SOUTH	5'	2.3'		
VUA = 5.0%	595 SF	687 SF		
INTERIOR LANDSCAPE	3 TREES	2 TREES		

### NOTES:

- SERVICE STRUCTURES MUST BE SCREENED IN ACCORDANCE WITH 10.2.6 OF THE LAND DEVELOPMENT CODE. SERVICE STRUCTURES INCLUDE BUT ARE NOT LIMITED TO: PROPANE TANKS, DUMPSTERS, HVAC UNITS, ELECTRIC TRANSFORMERS, TELECOM BOXES.
- LIGHT POLES, SIDEWALKS, BENCHES, ETC. SHALL NOT OCCUPY MORE THAN 25% OF ANY INTERIOR LANDSCAPE AREA (ILA) OR REDUCE THE WIDTH OF ANY PLANTED AREA TO LESS THAN 4 FEET. CONTRACTOR TO COORDINATE LIGHT POLE LOCATIONS WITH LANDSCAPE PLAN. LIGHT POLES SHALL NOT BE IN CONFLICT WITH PROPOSED PLANTINGS. 10.2.13.
- GRASS OR GROUND COVER SHALL BE PLANTED ON ALL PORTIONS OF THE LANDSCAPE BUFFER AREA NOT OCCUPIED BY OTHER LANDSCAPE MATERIAL.
- THE GROUND PLANE OF ALL INTERIOR LANDSCAPE AREAS SHALL BE PLANTED USING EITHER SHRUBS, GROUND COVER, OR TURF.
- IT WILL BE THE RESPONSIBILITY OF THE PROPERTY OWNER TO PERPETUALLY MAINTAIN ALL LANDSCAPE AREAS AND ASSOCIATED PLANT MATERIAL REQUIRED UNDER LAND DEVELOPMENT CODE REGULATIONS. THE PROPERTY OWNER SHALL ALSO BE RESPONSIBLE FOR MAINTAINING THE VERGE AND ASSOCIATED TREES WITHIN THE VERGE LIMITS. THE AGENCY HAVING JURISDICTION OVER THAT VERGE ASSUMES THAT RESPONSIBILITY.
- ALL UNHEALTHY OR DEAD PLANT MATERIAL SHALL BE REMOVED WITHIN ONE YEAR, OR BY THE NEXT PLANTING PERIOD, WHICHEVER COMES FIRST WHILE UNDER CONTRACT. IF NOT REMOVED, THE OWNER SHALL BE RESPONSIBLE FOR REMOVAL WITHIN THREE (3) YEARS.
- PLANT MATERIAL LOCATED WITHIN A UTILITY EASEMENT THAT IS DAMAGED BY THE COMPANY SHALL BE IMMEDIATELY REPAIRED BY THE COMPANY IN ACCORDANCE WITH THE UTILITY COMPANY'S REQUIREMENTS.
- STREETS TREES SHALL BE PLANTED IN ACCORDANCE WITH THE CITY OF LOUISVILLE'S STREET TREE SPECIFICATIONS. DOES NOT AFFECT PUBLIC SAFETY OR MAINTAIN SIGHT DISTANCE.

**CSX RAILROAD**  
FORMERLY LOUISVILLE,  
CINCINNATI & LEXINGTON  
RAILROAD COMPANY  
D.B. 153 PG. 214

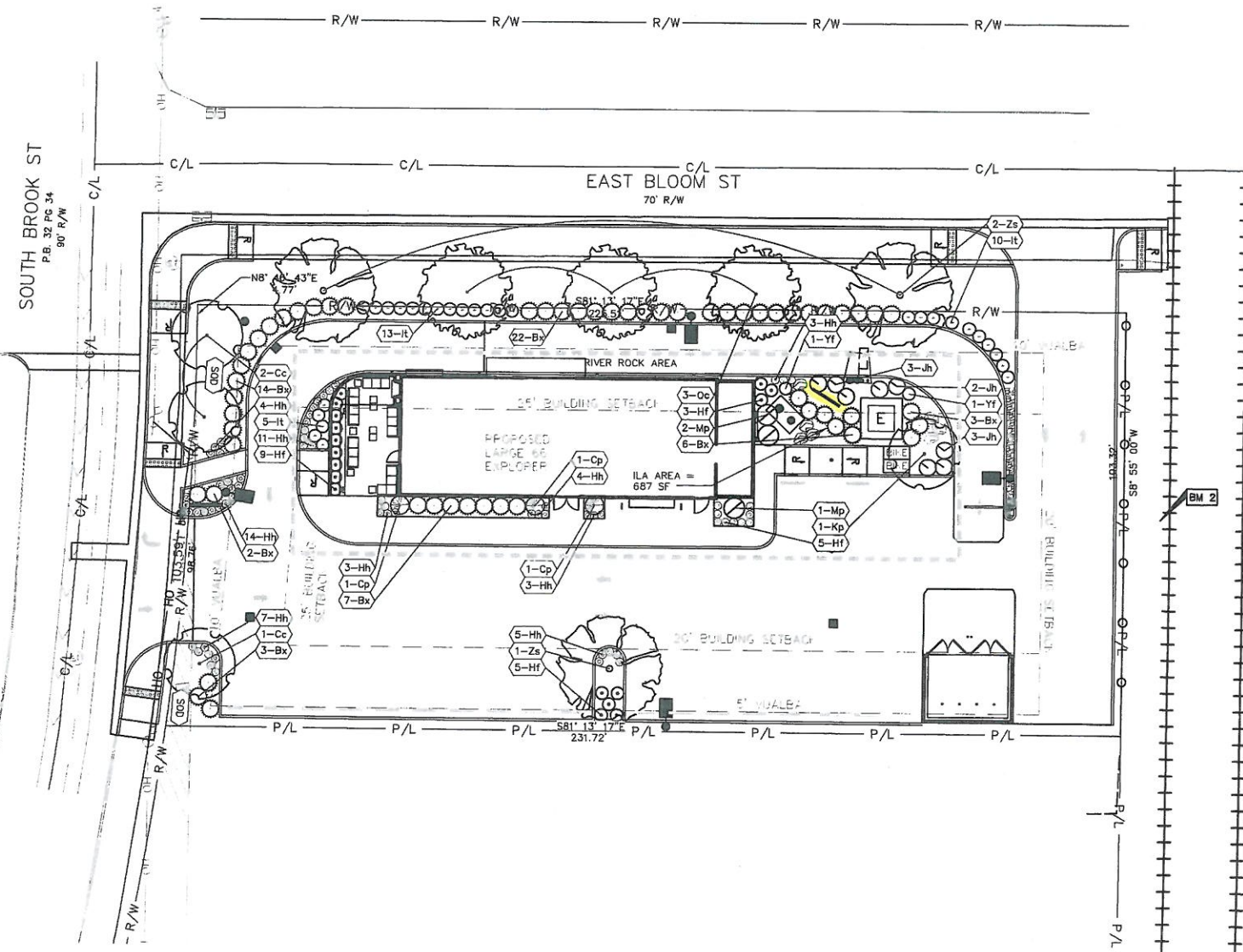

## PLANT LIST

Symbol	Botanical Name	Common Name	Qty.	Min. Size	Condition	Remarks
Bx	Buxus 'Wintergreen'	Wintergreen Boxwood	60	18" H Min.	Cont.	3' o/c
Cc	Cercis canadensis 'Appalachian Red'	Appalachian Red Redbud Tree	3	2" Cal.	B&B	Speciman
Cp	Chamaecyparis pisifera 'Golden Map'	Golden Map False Cypress	3	24" H Min.	Cont.	Specimen
Hf	Hypericum frondosum 'Sunburst'	Sunburst St. Johns Wort	17	18" H Min.	Cont.	3' o/c
Hh	Hemerocallis 'Happy Returns'	Happy Returns Daylily	65	No. 1	Cont.	1.5' o/c
It	Itea virginica 'Henry's Garnet'	Virginia Sweetspire	28	18" H Min.	Cont.	3' o/c
Jh	Juniperus horizontalis 'Wiltonii'	Creeping Juniper	8	No. 5	Cont.	4' o/c
Kp	Koeleruteria paniculata	Golden Rain Tree	1	2" Cal.	B&B	Speciman
Mp	Myrica pensylvanica 'Bobzam'	Bobee Northern Bayberry	3	24" H Min.	Cont.	4' o/c
Oc	Quercus coccinea	Scarlet Oak	3	3" Cal.	B&B	Speciman
Yf	Yucca filamentosa 'Golden Sword'	Golden Sword Yucca	2	No. 3	Cont.	2.5' o/c
Zs	Zelkova serrata 'Green Vase'	Green Vase Zelkova	3	2" Cal.	B&B	Speciman

**RECEIVED**

SEP 14 2015

PLANNING &  
DESIGN SERVICES



### BENCHMARKS:

BENCHMARK #1  
N 266125.86  
E 1207752.46  
ELEVATION=453.35  
  
BENCHMARK #2  
N 266105.96  
E 1208035.94  
ELEVATION=456.36

ISSUED FOR CONST. 08.26.15

CONTINUED: 08.26.15  
BUILDING TYPE: EXPLORER  
PLAN VERSION: June 2015  
SITE NUMBER: 310631 / 428936  
STORE NUMBER: 2014088.15

TACO BELL

1801 S BROOK ST  
LOUISVILLE, KY 40208



**EXPLORER**  
LARGES

**LANDSCAPE PLAN**

**L-101**

PLOT DATE:

15 VARIANCE 10.63