

14ZONE1061

Cane Run Road Facility



Planning/Zoning, Land Design & Development
May 19, 2015

Location

- 3650 Cane Run Road
- Council District 1 – Jessica Green

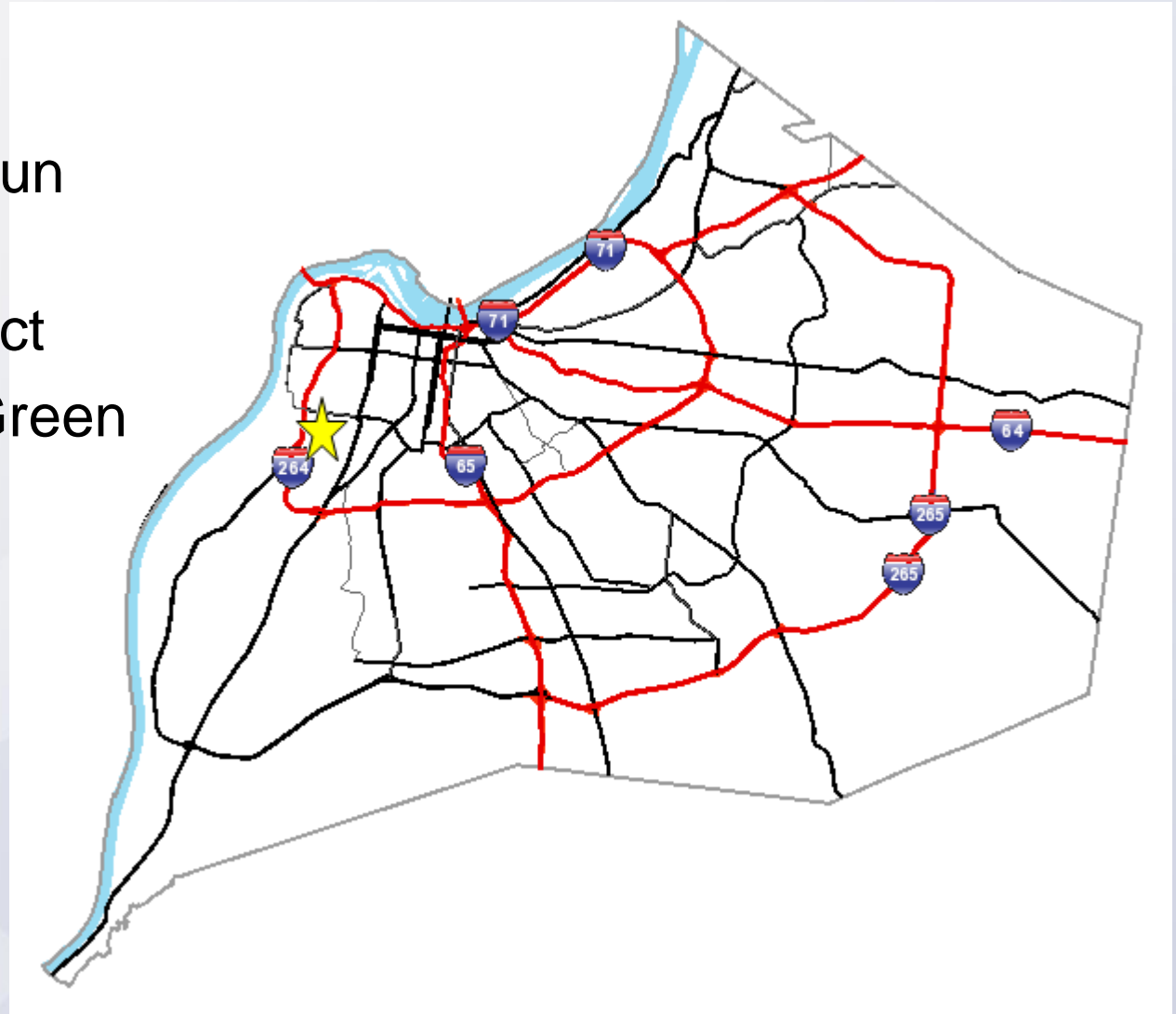

Request(s)

- Change in Zoning from R-6 to EZ-1
- District Development Plan

Case Summary / Background

- 16,300 sf building
- Vacant lot
- Mature trees exist on the mainly flat site

Zoning/Form Districts

Subject Property:

- Existing: EZ-1 & R-6/TW
- Proposed: EZ-1/TW

Adjacent Properties:

- North: EZ-1/TW
- South: EZ-1/TW
- East: EZ-1/TW
- West: EZ-1/TW

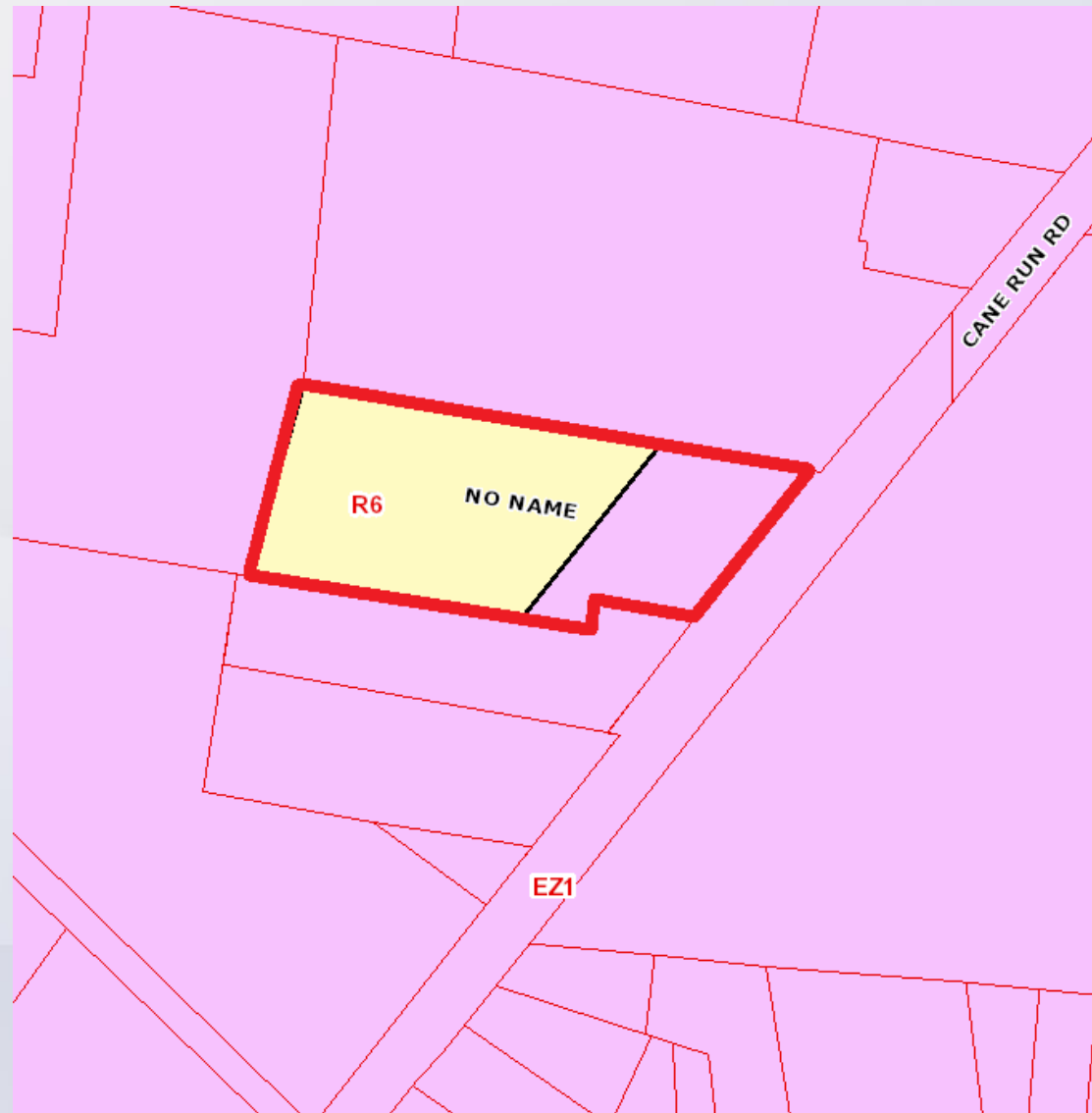

Aerial Photo/Land Use

Subject Property:

- Existing: Vacant
- Proposed: Warehouse

Adjacent Properties:

- North: Church
- South: Warehouse
- East: Industrial
- West: Industrial



Site Photos-Subject Property



Applicant's Development Plan

Highlights:

- Warehouse
- 16,300 Square Feet
- 21 Parking spaces

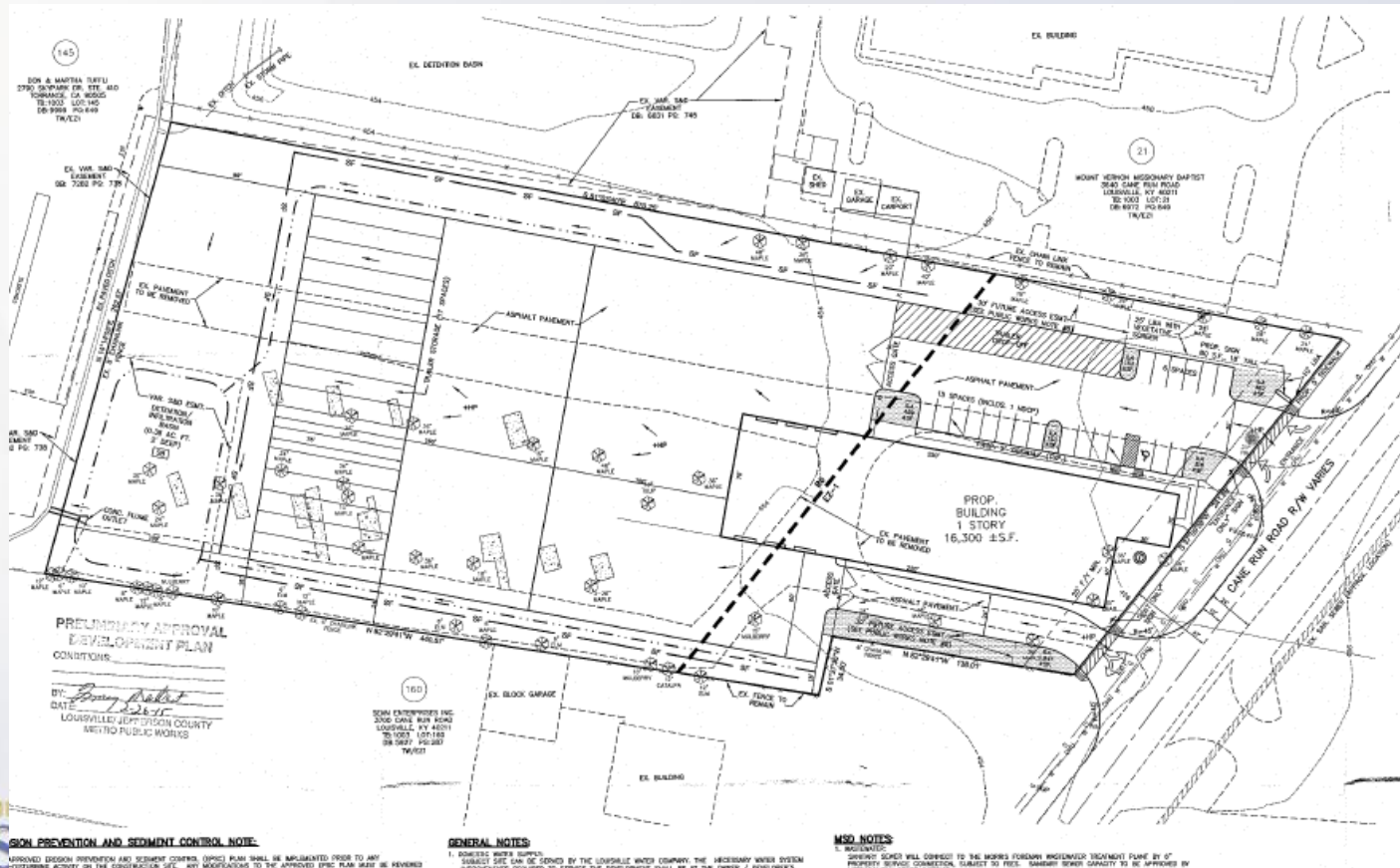

PC Recommendation

- Public Hearing was held on 4/16/2015
 - No one spoke in opposition to this request.
- The Commission made sufficient findings that the proposal complies with the Comprehensive Plan-Cornerstone 2020
- The Commission unanimously recommended approval of the zoning change from R-6 to EZ-1 to Louisville Metro Council (6 members voted)